

Building and Facility List					
Building Number	Elevations (Ft. MSL)		Description	Current Status	Ultimate Disposition
	Roof	Floor			
NORTHEAST QUADRANT					
14	739	739	Commercial Vehicle Staging (Taxi & Door to Door)	Existing	Remain
15A	711	711	Temporary Economy Public Surface Parking Lot A	Existing	Demolish
15F	719	719	Temporary Employee Surface Parking Lot	Existing	Demolish
50	784	760	Truck Fill Fuel Island Area Canopy	Existing	Remain
50A	773	759	Fuel Administration	Existing	Remain
60	768	735	Lease Building	Existing	Remain
61	762	735	Lease Building	Existing	Remain
62	811	714	FAA Air Traffic Control Tower (ATCT)	Existing	Remain
62A	726	714	FAA Base Building	Existing	Remain
63	760	735	Replacement Passenger Terminal - Processor - First Level	Proposed	Future
63A	760	745-730	Replacement Passenger Terminal - Secure Concourse First Level	Proposed	Future
63B	735	720	Replacement Passenger Terminal - TSA Building Basement Level	Proposed	Future
63C	780	755	Replacement Passenger Terminal - Offices - Second Level	Proposed	Future
64	832	734	Public Auto Parking Garage North	Proposed	Future
64A	832	734	Public Auto Parking Garage South	Proposed	Future
64B	753	N/A	Environmental Canopy/View Corridor	Proposed	Future
65	796	738	Employee Parking Structure	Proposed	Future
66	781	741	Central Utility Plant	Proposed	Future
67	770	744	Replacement Airline Cargo Building	Proposed	Future
68	760	745	Replacement GSE and Terminal Maintenance Building	Proposed	Future
69	750	723	Replacement ARFF Station First Level	Proposed	Future
69A	765	750	Emergency Operations & Communications Center (EOCC) Second Level	Proposed	Future

Building and Facilities Legend		
Existing	Ultimate	Description
[Symbol]	[Symbol]	Taxiway Pavement
[Symbol]	[Symbol]	Aircraft Apron
[Symbol]	[Symbol]	On Airport Building/Facility
[Symbol]	[Symbol]	Off Airport Commercial Building/Facility
[Symbol]	[Symbol]	Airport Building/Facility To Be Removed
[Symbol]	[Symbol]	Airport Vehicle Service Road
[Symbol]	[Symbol]	Airport Public Road
[Symbol]	[Symbol]	Non-Aviation Airport Tenant Leasehold
[Symbol]	[Symbol]	Canopy
[Symbol]	[Symbol]	Airport Public Surface Auto Parking Lot
[Symbol]	[Symbol]	Authority/Government Vehicle Surface Parking/Staging
[Symbol]	[Symbol]	No Taxi Island or Shoulder
[Symbol]	[Symbol]	Tenant Auto Surface Parking
[Symbol]	[Symbol]	Engineered Material Arresting System (EMAS)

Symbol Legend	
[Symbol]	Airport Reference Point (ARP)
[Symbol]	Existing Runway Lighting
[Symbol]	Existing Threshold Lights
[Symbol]	Touchdown Zone Elevation
[Symbol]	Runway Low Point Elevation
[Symbol]	Runway High Point Elevation
[Symbol]	Section Corner
[Symbol]	Concrete Encased Survey Monument
[Symbol]	Airfield Wind Cone
[Symbol]	PACS (Primary Airport Control Station)
[Symbol]	SACS (Secondary Airport Control Station)

Line Legend	
[Symbol]	Existing Property Boundary (Offset 5' For Clarity)
[Symbol]	Existing Contours (in Feet-MSL)
[Symbol]	Railroad Track
[Symbol]	City Boundary Line
[Symbol]	Building Restriction Line (BRL)
[Symbol]	Runway Safety Area - See Note 2.1
[Symbol]	Taxiway Safety Area
[Symbol]	Obstacle Free Zone - See Note 2.2
[Symbol]	Object Free Area - See Note 2.3
[Symbol]	Extended Centerline
[Symbol]	Localizer Critical Area
[Symbol]	Glide Slope Critical Area
[Symbol]	Aircraft Parking Limit Line (APLL)
[Symbol]	Departure Runway Protection Zone - See Note 2.4
[Symbol]	Approach Runway Protection Zone - See Note 2.4
[Symbol]	Runway Protection Zone - See Note 2.4
[Symbol]	Taxiway Object Free Area

Fencing and Barrier Legend	
[Symbol]	Block Wall with C.L. Fence
[Symbol]	Frangible Metal Beam Guard Rail
[Symbol]	Concrete K-Rail
[Symbol]	Blast Fence
[Symbol]	Existing C.L. Fence (8" with 15" Dia. Razor Wire)
[Symbol]	Future C.L. Fence (8" with 15" Dia. Razor Wire)
[Symbol]	Existing Non-Security Fence

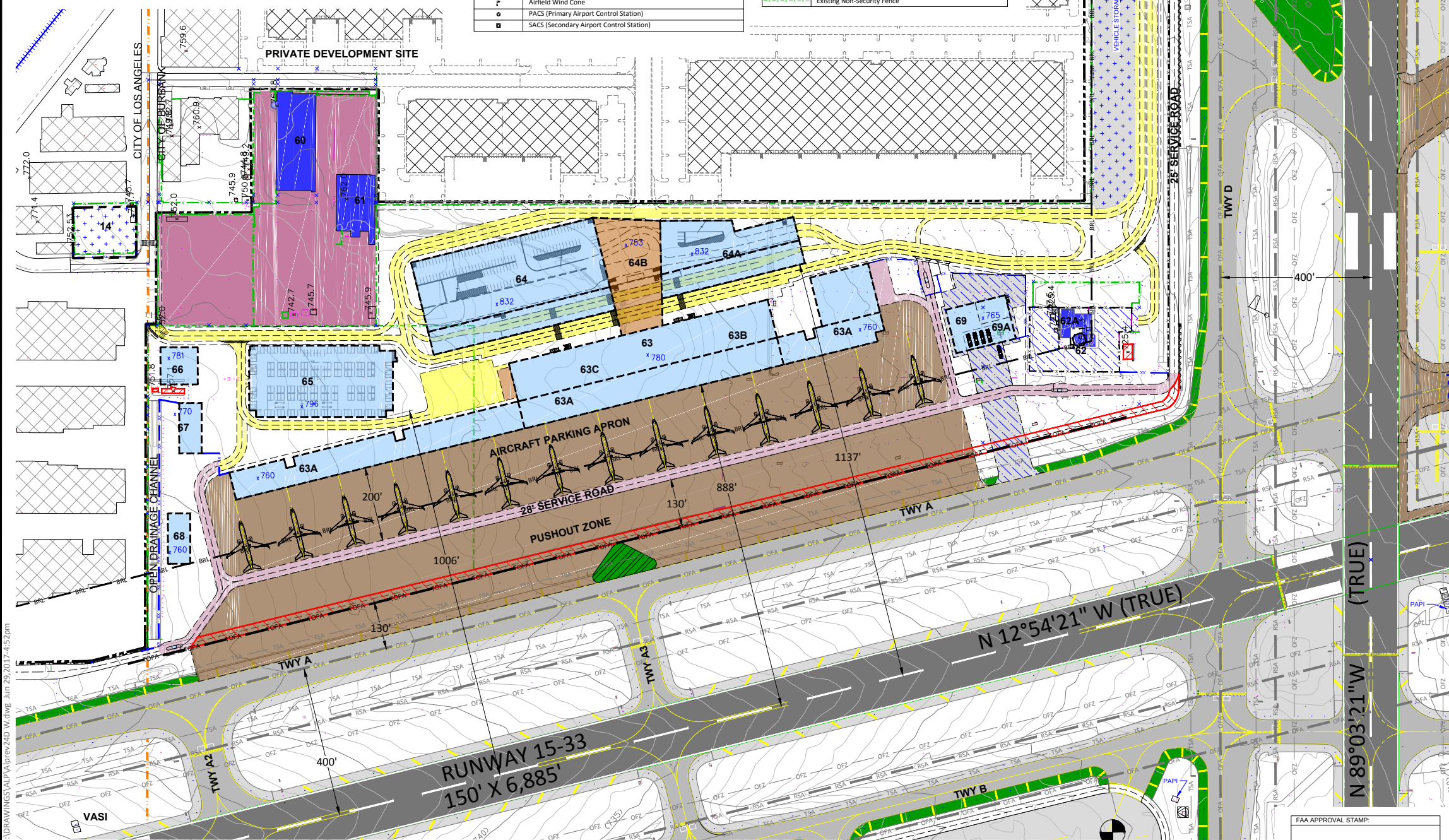

BOB HOPE AIRPORT
 2627 N. HOLLYWOOD WAY
 BURBANK CALIFORNIA 91505
 (COMMONLY KNOWN AS HOLLYWOOD BURBANK AIRPORT)

AIRPORT LAYOUT PLAN DRAWING SET

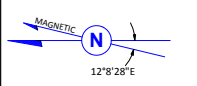

RATE OF CHANGE
 0'S 14\"/>

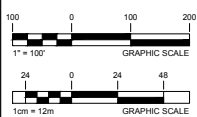

SHEET TITLE:
FUTURE TERMINAL AREA PLAN

APPROVED:
 BURBANK-GLENDALE-PASADENA AIRPORT AUTHORITY

EXECUTIVE DIRECTOR _____

DATE _____

SENIOR DEPUTY EXECUTIVE DIRECTOR _____

DATE _____

DATE: JUNE 30, 2017

DRAWN BY: DL

CHECKED BY: MDC

SHEET No:
6
 OF 16

S:\DRAWINGS\ALP\Alprev24D W.dwg Jun 29, 2017 4:52pm

DATE	DESCRIPTION	BY	DATE	DESCRIPTION	BY

NOTE:
 This drawing is for planning purposes only and not intended for navigational purposes. The content of this drawing and Plan do not necessarily reflect the official views or policy of the Federal Aviation Administration (FAA). Acceptance of this document by the FAA does not in any way constitute a commitment on the part of the United States to participate in any development depicted.

FAA APPROVAL STAMP: